

OTHER INSTRUMENTS

INSTRUMENTS FOR THE OPTICAL WORKSHOP

Besides the modular designed testing telescopes and collimators MÖLLER-WEDEL OPTICAL offers a whole lot of other telescopes and collimators for diverse measuring tasks in the optical workshop.

For alterations of the magnification interchangeable eyepiece $f=10$ mm and $f=25$ mm can be used as an option.

DIOPTER TELESCOPES

Fig. A

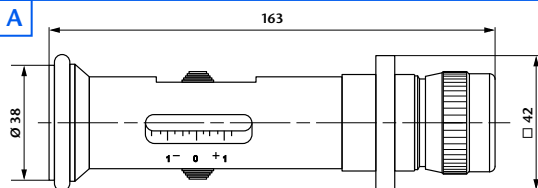
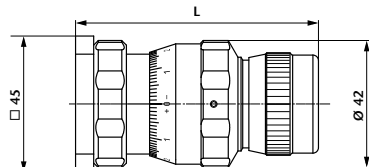

Fig. B



Description:

Diopter telescopes are adjustable focus telescopes that serve the measurement of optical power of lenses in diopter. The measuring result can be directly read from the diopter graduation.

Application examples:

- Fast testing of optical power
- Testing the diopter graduation and infinity adjustment of eyepieces
- For additional enlargement on telescopes, e.g. when adjusting reticles
- As Reading Telescope in the negative distance range

Ident.-Nr.	Description	Meas. range	Scale division	Field of view at ∞	Focal length	L	Fig.
233 202	Diopter telescope $\pm 1,5$	+1,5 to -1,5 dpt	0,25 dpt	6°	90 mm	–	A
233 212	Diopter telescope +6,0/-3,0	+6,0 to -3,0 dpt	0,20 dpt	11°	50 mm	79...99	B
233 222	Diopter telescope +0,2/-5,8	+0,2 to -5,8 dpt	0,20 dpt	11°	50 mm	90...110	B
233 234	Diopter telescope $\pm 5,0$	+5,0 to -5,0 dpt	0,10 dpt	13°	40 mm	76...93	B

DYNAMETER

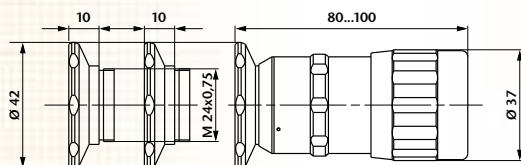

Description:

- For measurement of telescope magnification
- For diameter measurement of the exit pupil
- For measurement of the distance between exit pupil and eyepiece
- Lens magnification 7,5x

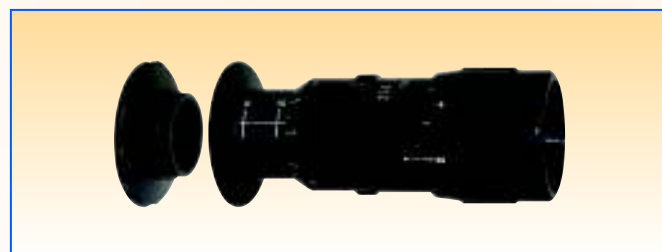

Ord.-No.	Description
233 241	Dynameter
233 245	Tube attachment 10 mm