

MODULAR COMPONENTS

OBJECTIVE TUBES

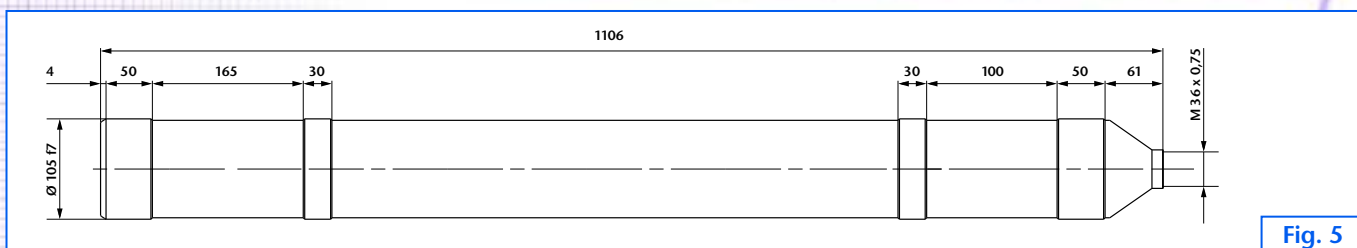
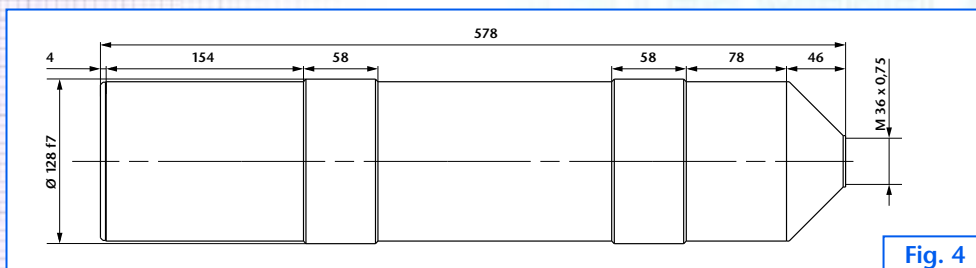
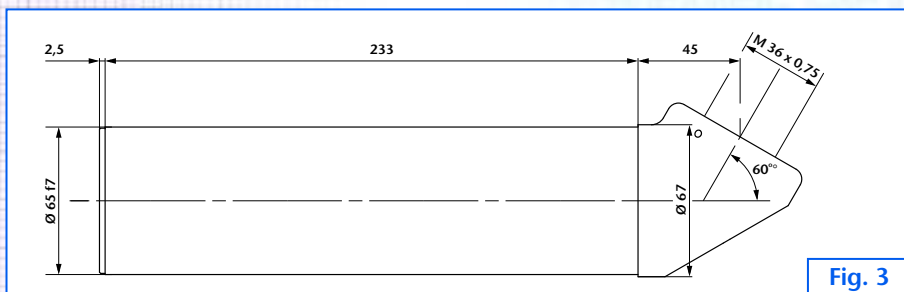
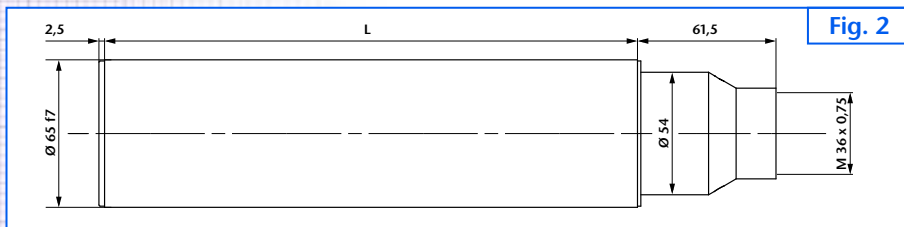
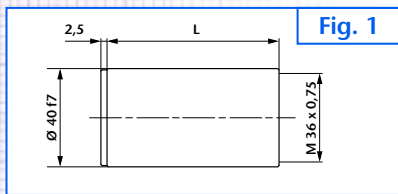

Ord.-No.	Description	Focal length	Free aperture	L	Fig.
211 210	Objective tube 90/40	90	16	65	1
211 220	Objective tube 140/40	140	28	118	1
211 230	Objective tube 200/40	200	28	173	1
211 240	Objective tube 300/40	300	28	274	1
211 250	Objective tube 500/40	500	28	474	1
211 301	Objective tube 300/65	300	50	233	2
211 310	Objective tube 500/65	500	50	415	2
211 330	Objective tube 500T/65	500	50	233	2
211 526	Objective tube 500T/65W	500	50	-	3
211 347	Objective tube 600/128	600	100	-	4
211 401	Objective tube 1100/105	1100	78	-	5